

ZX-PA Series—Installation Guide

Specifications

Input Impedance..... 5000 Ω \pm 10%
 Excitation Voltage (+Vin)..... 25 VDC Max.
 Output Impedance..... 0 to 5000 Ω
 Linearity..... \pm 1.0% Full Scale
 Operating Temperature..... 55°C to 100°C

Electrical Cable Wiring

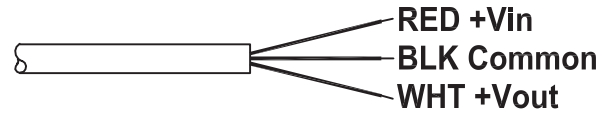

Dimensional Info

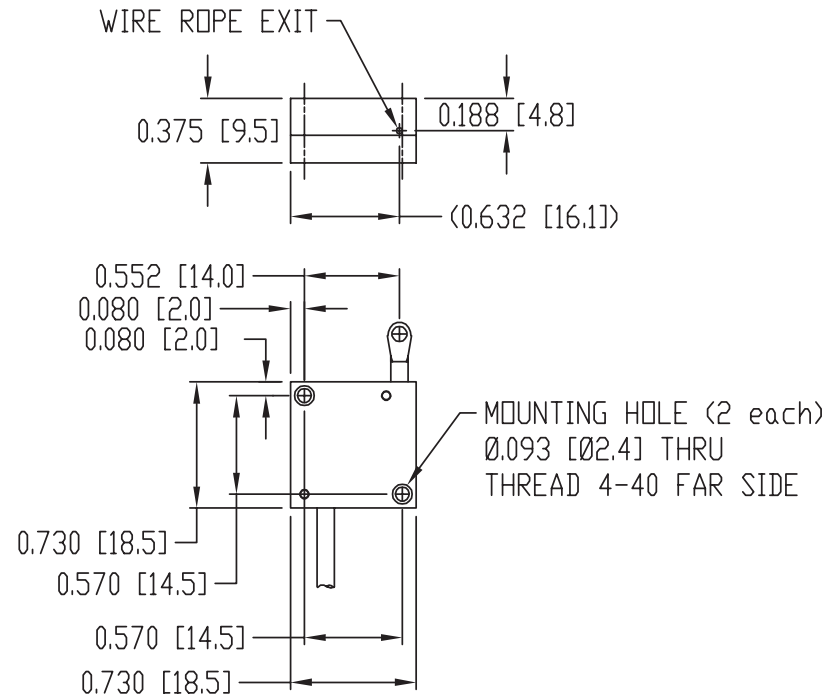

Eye Fitting-OPTION A

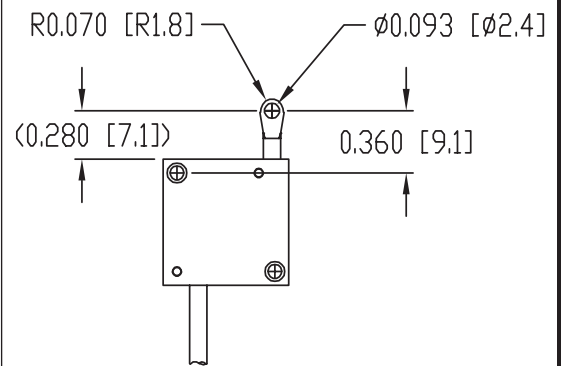

Leader Wire Rope with Clip-OPTION B

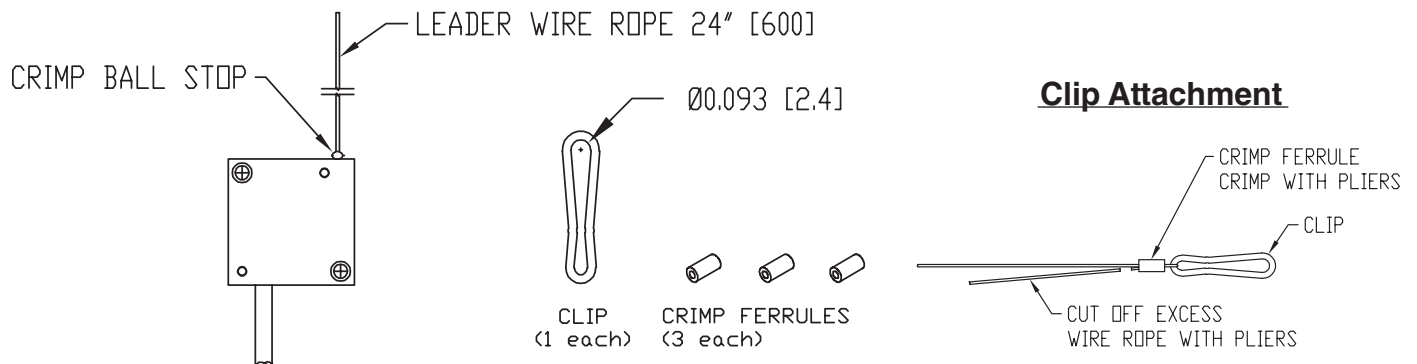

Dimensions in brackets are in millimeters