

ZX-HM Series – Installation Guide

Specifications

Excitation Voltage (Ve) 5.00±0.25 VDC
 Excitation Current 21 mA Max.
 Minimum Load Impedance 30KΩ
 Linearity ±1.0% Full Scale
 Operating Temperature -40°C to 125°C

Electrical Cable Wiring

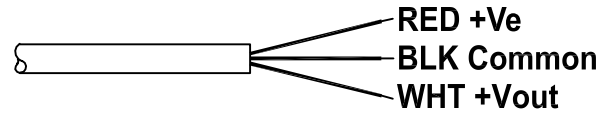

Dimensional Information

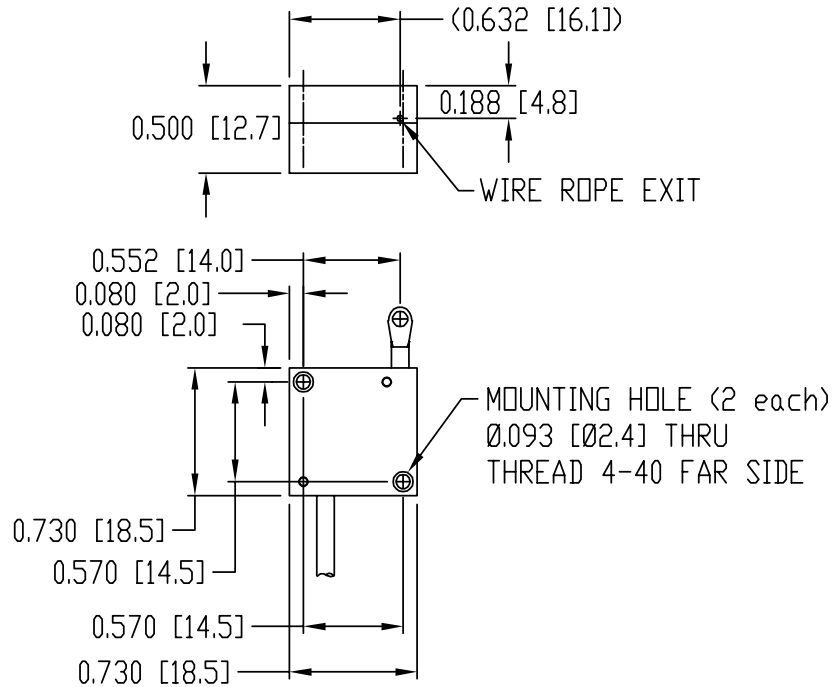

OPTION A – Eye Fitting

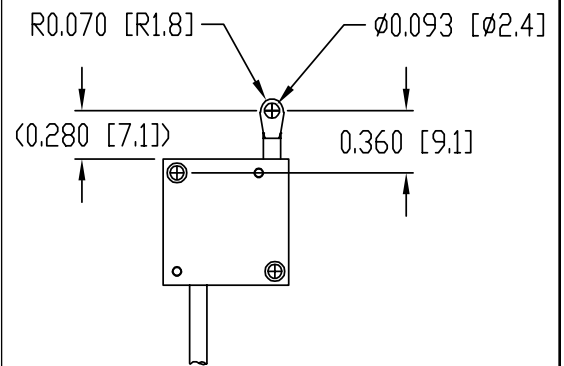

OPTION B – Leader Wire Rope with Clip

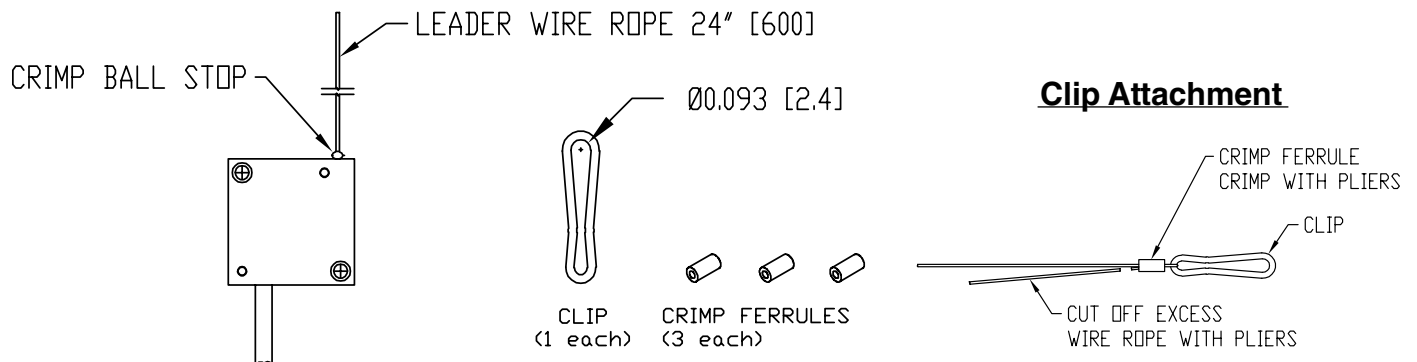

Dimensions in brackets are in millimeters